

Gyrocompass (NAVIGAT X MK1)



Attention:

The system is mandatory for nautical purpose. The operation belongs to the bridge only.

Summary

The NAVIGAT X MK 1 is a digital gyrocompass system for the maritime navigation of vessels. It provides North-speed error corrected true heading data as well as rate of turn (ROT) data for the navigation of maritime vessels.

Manufacturer	Sperry Marine
Model	NAVIGAT X MK1
Serial No.	16700
Type	compass
REGISTRY-Link	REGISTRY (1616)



Gyrocompass

Locations on RV Heinckes forecastle

Umformerraum
(Gyrocompass, DWD Data Acquisition,
Barometric Pressure Sensor, Storage of
GAPS and Fishnet Echo Sounder Transponder)

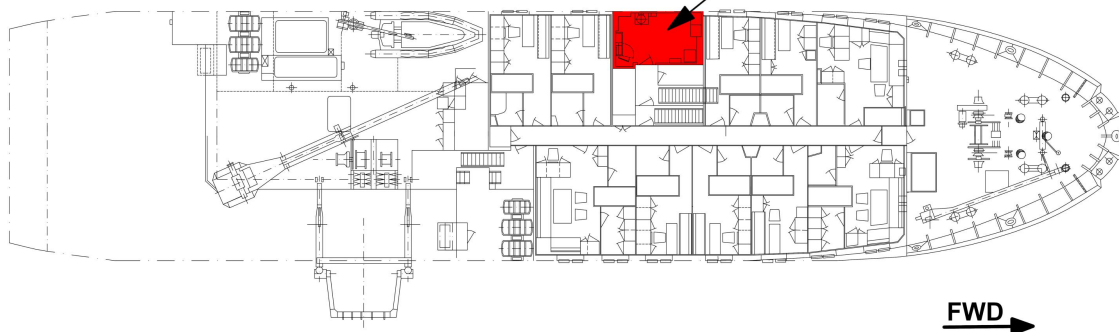

Contacts

Name	Institution	Role
------	-------------	------

Reederei Briese	Briese Schifffahrts GmbH & Co. KG	Engineer In Charge
-----------------	-----------------------------------	--------------------

Components

The system consists of the gyro compass installed in Umformerraum in the forecastle.

No subdevices available.

Position

Info	The gyrocompass is located in the Umformerraum in the forecastle.
X	0.0 (no unit given) (no description given)
Y	0.0 (no unit given) (no description given)
Z	0.0 (no unit given) (no description given)

Data logging, storage and archiving

Logged parameters

Parameter	O2ARegistry Output Type	Unit
gyrocompass heading	attitude	deg

Central geographical ship's position and time standard

Rawdata storage on board

DShip

Data archiving on land

Documentation

- [NAVIGAT X MK1 data sheet \(Factsheet, 1 MB\)](#)
- [NAVIGAT X MK1 manual \(User Manual, 12 MB\)](#)